

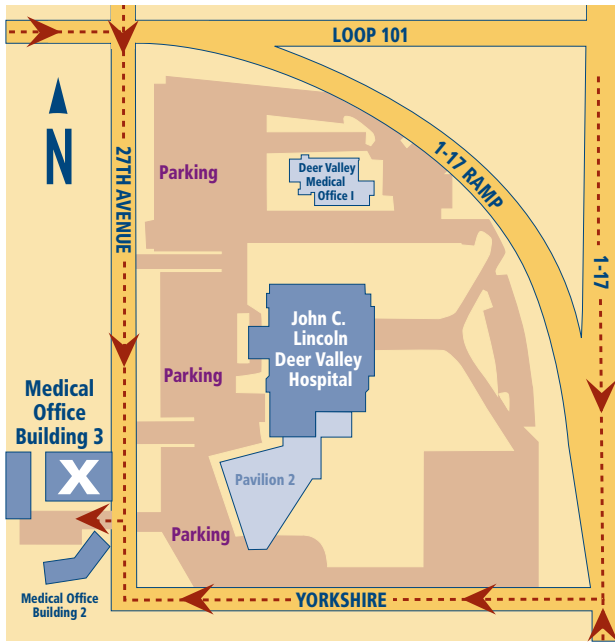

John C. Lincoln Breast Health and Research Center
 19646 N. 27th Ave., Suite 205
 623-780-HOPE (4673) ■ JCL.com/breasthealth

Surrounding Area



Loop 101: W or E to 27th Ave. Exit – S on 27th Ave.
I-17: N or S – Take Yorkshire Exit – Go West to 27th Ave. – Then North on 27th Ave.

Campus Map

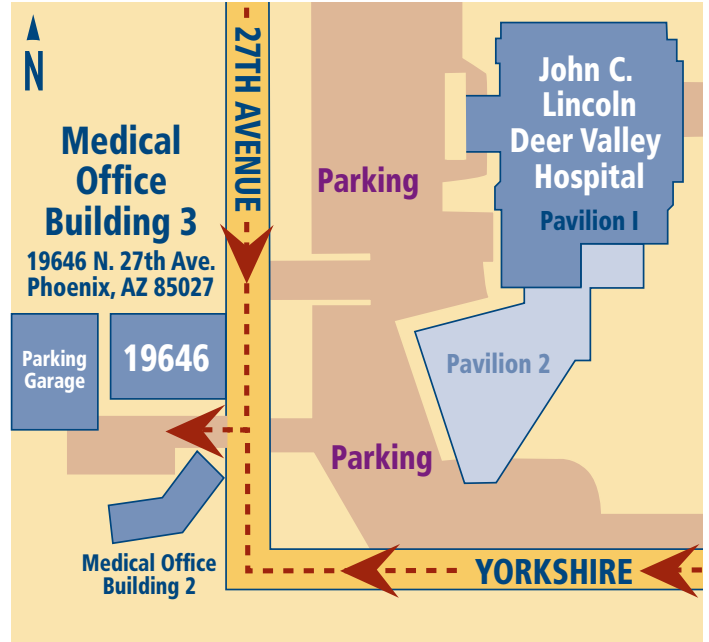

Limited parking in the front of the building or use the parking garage West of the building.

First Floor

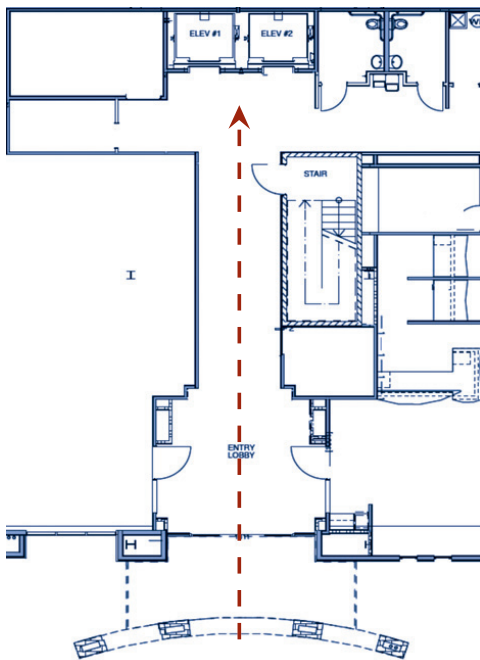

Go in the South entrance to the elevator.

Second Floor

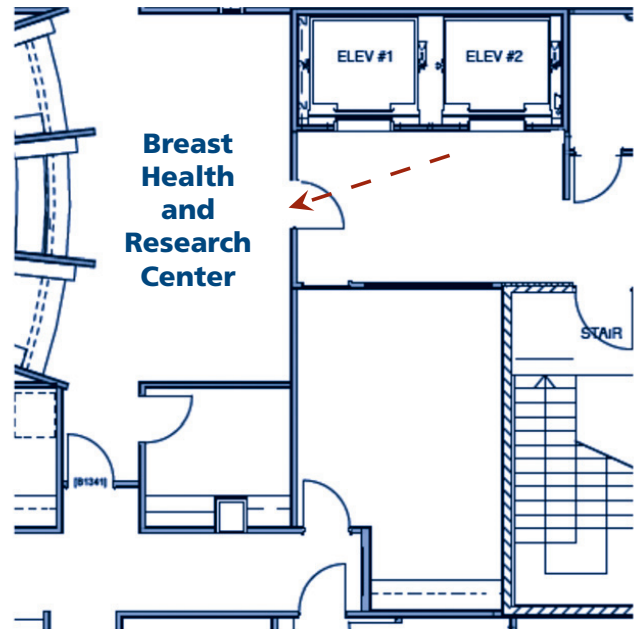

Go right off the elevator into the Suite 205.